

**DPSS-532-NL**

**GREEN LASERS: 532 nm, 100~800 mW**



- Miniature size
- Collimated straight beam
- Adjustable focus
- Easy use & maintenance free
- Longlife operation
- High efficiency
- High reliability

**APPLICATIONS**

- Laser show
- Display
- Laser Alignment
- Scanning Biochemistry
- Material Inspection LIDAR

**SPECIFICATIONS**

Wavelength	532 nm
Spatial Mode	TEM <sub>00</sub>
Output Power	>100, >200, ..., >800 mW
Residual IR (1064, 808, 946 nm etc)	<0.01%
Operation Mode	CW or Modulation
Modulation	0~30 khz Analog or TTL
Beam Spot Shape	Circular, aspect ratio <1.1 : 1
Pointing Stability	<0.05 mrad
Beam Diameter (1/e <sup>2</sup> )	<2.5 mm
Beam Divergence (full angle)	<1.5 mrad
Power Stability	<±5% per 4 hrs
Temperature Stabilizing	TEC
Warm Up Time	<1 minutes
Expected Lifetime	10,000 hrs
Laser Head Dimensions	40(W) × 100(L) × 50(H) mm (optional fan adds 15 mm height)
<b>POWER SUPPLY</b>	
OEM type <b>EO-PS-I</b>	58(W) × 100(L) × 32(H) mm AC/DC PSU: 85~265 V 50/60 Hz input
Lab type <b>EO-PS-IIS</b>	104(W) × 128(L) × 89(H) mm 85~265V 50/60 Hz input
Lab Adjustable type <b>EO-PS-II</b>	179(W) × 148(L) × 56(H) mm 85~265 V 50/60 Hz input

**ORDERING INFORMATION**

Catalogue number	Description
DPSS-532-NL100	100 mW
DPSS-532-NL200	200 mW
DPSS-532-NL300	300 mW
DPSS-532-NL400	400 mW
DPSS-532-NL500	500 mW
DPSS-532-NL600	600 mW
DPSS-532-NL700	700 mW
DPSS-532-NL800	800 mW
EO-PS-I	OEM type power supply
EO-PS-IIS	Lab type power supply
EO-PS-II	Lab adjustable type power supply

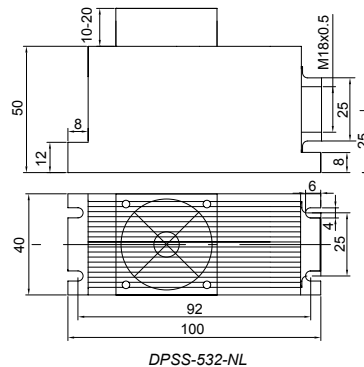

**POWER SUPPLIES**

- OEM power supply **EO-PS-I**
- Lab type power supply **EO-PS-IIS**
- Lab adjustable type power supply **EO-PS-II**



**RELATED PRODUCTS**

Laser Safety Eyewear  
See page 1.16.

